

# Starpoint Series 2 Push Button Range Product Summary

## Introduction

The Series 2 Push Button range has a variety of different designs with softer bezel styling in addition to some Classic styles, allowing the games designer the flexibility to select a Push Button to meet his needs.

## Electrical Outline

The Series 2 Push Button range can be supplied in both Spade Terminal and AT (Advanced Technology ) Build options.

## Mechanical Outline

Dimensional information of overall sizes & shapes of the Series 2 Push Button range is include on the space envelope of this document, together with individual button insert & panel cutout sizes.

## Sample Ordering

When requesting samples a brief specification is required which identifies the basic options.

<b>Button Type</b>	Choose from table	
<b>Build Type</b>	Spade Build Option	AT Build Option

If you require a sample, fax Starpoint on +44 (0)20 8391 7760 with you required options and intended application. The sample will be sent, together with details of how to specify your exact product requirement.

## Starpoint Series 2 Push Button Range Dimensional Information

### Space Envelope

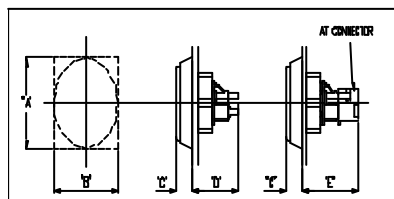

TYPE	A	B	C	D	E
SS201	27.0	27.0	12.0	31.5	37.0
SS204	48.0	48.0	13.5	31.5	37.0
SS212	33.5	33.5	10.5	34.0	38.5
SS214	51.4	51.4	14.0	34.0	38.5
RS201	33.0	27.0	12.0	31.5	37.0
RS203	46.0	27.0	12.0	31.5	37.0
RS214	51.0	33.0	14.0	34.0	38.5
RS214	59.5	58.5	10.5	43.0	48.5

## Starpoint Series 2 Push Button Range Dimensional Information

### Insert & Panel Cutout Size's

**NB:** Unless stated otherwise the orientation is viewed from the front of the Push Button.

#### a] SS201

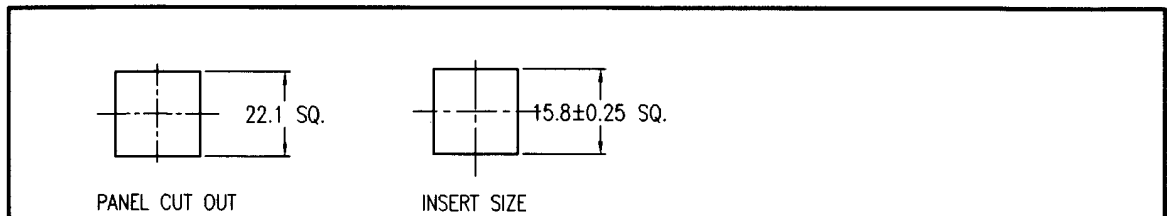

#### b] SS204

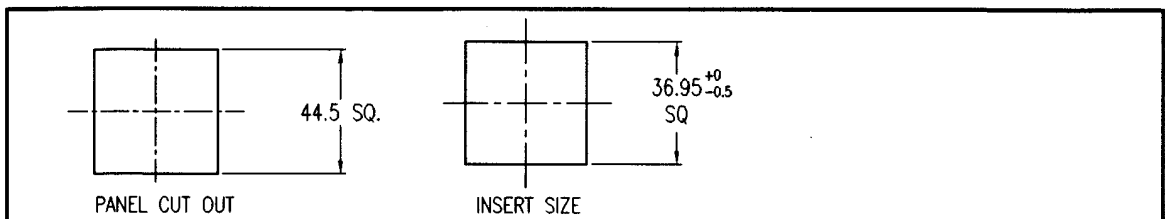

**NB:** Panel cut-out dimensions for the low profile configuration. For high profile assembly use SS201 cut-out dimension.

#### c] SS212

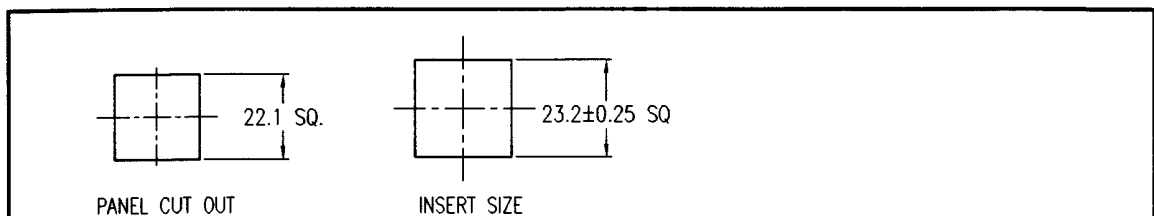

#### d] SS214

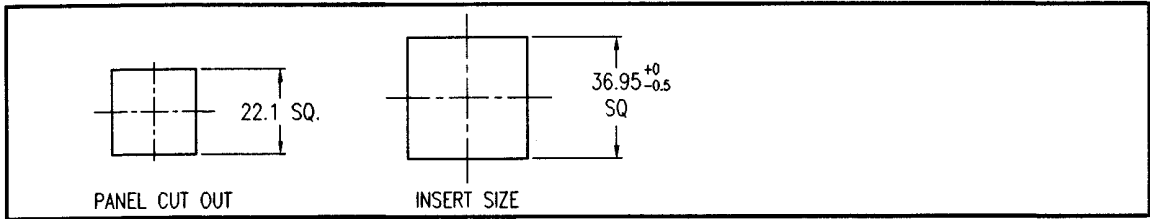

**e] RS201**

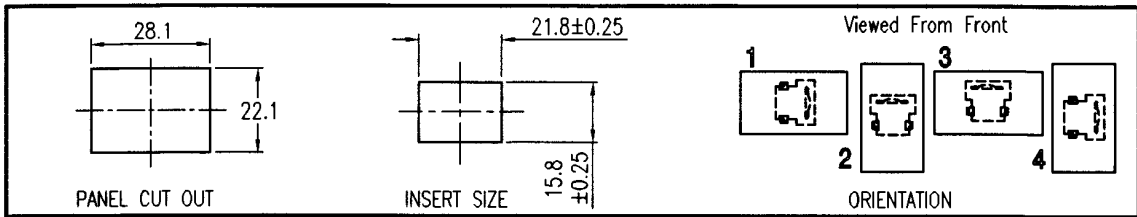

NB: Panel cut-out dimensions for the low profile configuration. For high profile assembly use SS201 cut-out dimension.

**f] RS203**

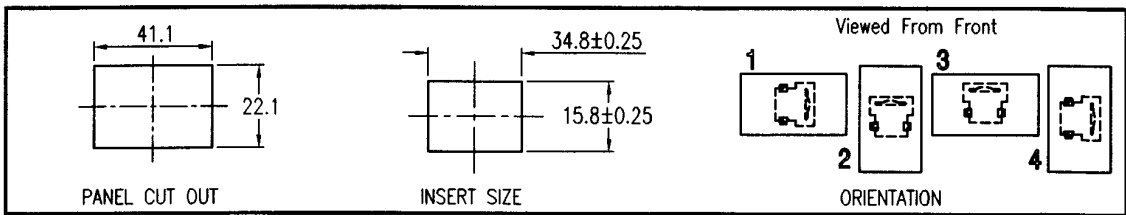

NB: Panel cut-out dimensions for the low profile configuration. For high profile assembly use SS201 cut-out dimension.

**g] RS214**

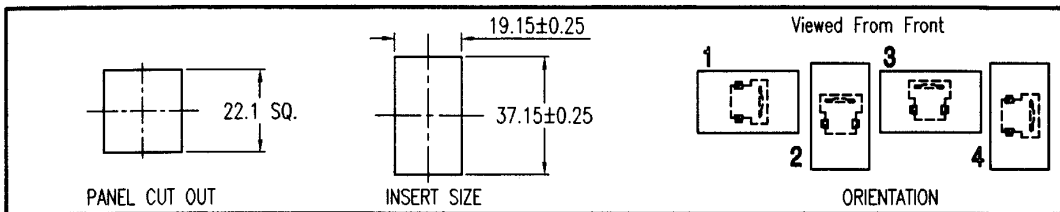

**h] CS204 & CS244**

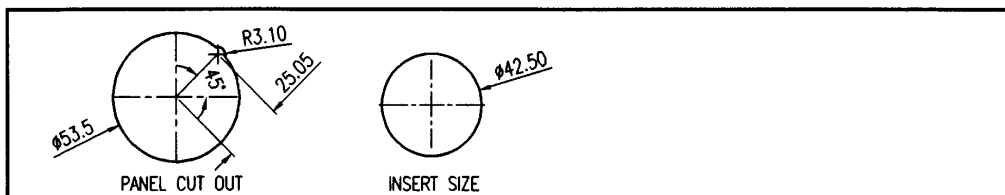

**i] CS224 & CS254**

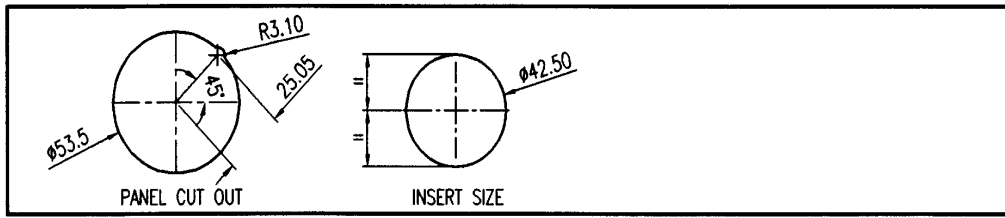

**j] OS204**

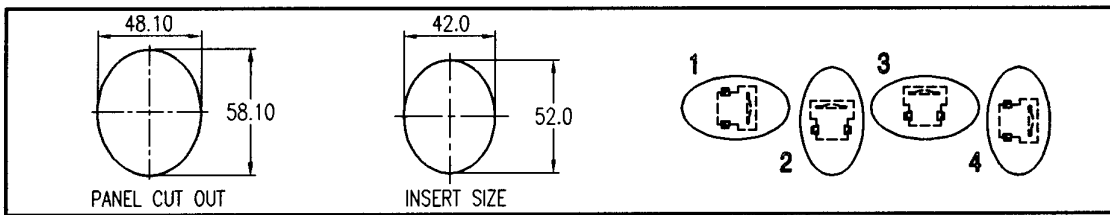

**k] OS224**

